

KAJK Series

Features

- Endurance : 105°C 2000H
- Specially designed for LED display screen
- Designed for reflow soldering
- Designed for surface mounting on high-density PCB
- RoHS 2.0 compliant
- 219 SVHC & REACH compliant



Marking color: Black

Specifications					
Category temp. range	-40℃ to +105℃				
Capacitance tolerance	±20% (120 Hz / +20 ℃)				
Leakage current	I ≤ 0.01 CV or 3 μA whichever is greater (after 2 minutes)				
Tan δ	Please see the attached characteristics list				
Characteristics at low temperature	Rated voltage (V)	10	16	Impedance ratio at 120 Hz	
	Z (-25 ℃) / Z (+20 ℃)	4	3		
	Z (-40 ℃) / Z (+20 ℃)	8	6		
Endurance	After applying rated working voltage for 2000 hours at +105 ℃ ± 2 ℃, and then being stabilized at +20 ℃, capacitors shall meet the following limits.				
	Capacitance change	Within ±30% of the initial value			
	Dissipation factor (tan δ)	Less than 300% of the initial value			
	Leakage current	Within the initial limit			
Shelf life	After storage for 1000 h at +105 ℃ ± 2 ℃ with no voltage applied and then being stabilized at +20 ℃, capacitors shall meet the limits specified in endurance.				
Resistance to soldering heat	After reflow soldering and then being stabilized at +20 ℃, capacitors shall meet the following limits.				
	Capacitance change	Within ±10% of the initial value			
	Dissipation factor (tan δ)	Within the initial limit			
	Leakage current	Within the initial limit			
Frequency correction factor for ripple current	Frequency	50Hz	120Hz	1kHz	10kHz≤
	Correction Factor	0.7	1.0	1.2	1.3

Dimensions:

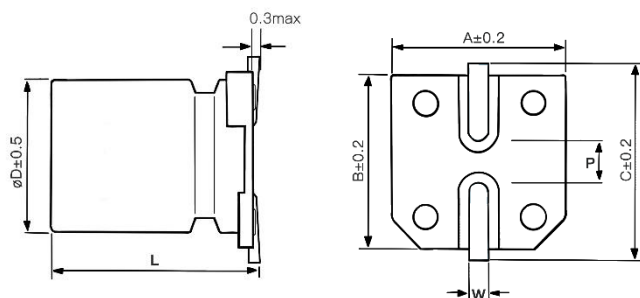

Dimensions						Unit: mm
φ D	L	A	B	C	W	P±0.2
6.3	5.7	6.6	6.6	7.3	0.5~0.8	2.2
6.3	7.7	6.6	6.6	7.3	0.5~0.8	2.2

Marking:

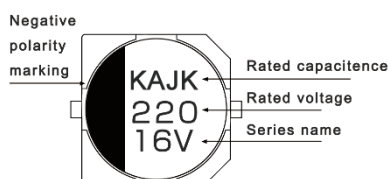

Part Number System:

KAJK series	16V	220μF	±20 %	6.3 φ X7.7L
KAJK	1C	221	M	0607
Series name	Rated voltage	Capacitance	Capacitance tolerance	Case Size

Characteristics list

Rated voltage (V)	Capacitance (±20%) (μF)	Case size		Specification		Part Number③	Taping&Reel
		øD (mm)	L (mm)	Rated ripple current① (mA rms)	tan δ②		MPQ (pcs/reel)
10	220	6.3	5.7	75	0.24	KAJK1A221M0606	1250
16	220	6.3	7.7	110	0.20	KAJK1C221M0607	1000

① Rated ripple current (120Hz / +105°C) ② tan δ (120Hz / +20°C) ③ For plastic reel packaging, the Part Number is appended with "PR" at the end.

※ Please refer to the page of reflow conditions for reflow profile.