

KVD Series

Features

- Endurance : 105°C 5000H
- Designed for High Voltage
- Designed for reflow soldering
- Designed for surface mounting on high-density PCB
- RoHS 2.0 compliant
- 219 SVHC & REACH compliant



Marking color: Black

Specifications					
Category temp. range	-40℃ to +105℃				
Capacitance tolerance	±20% (120 Hz / +20 ℃)				
Leakage current	I ≤ 0.04 CV +100μA, after 5 minutes				
Tan δ	Please see the attached characteristics list				
Characteristics at low temperature	Rated voltage (V)	400		Impedance ratio at 120 Hz	
	Z (-25 ℃) / Z (+20 ℃)	6			
	Z (-40 ℃) / Z (+20 ℃)	10			
Endurance	After applying rated working voltage for 5000 hours at +105 ℃ ± 2 ℃, and then being stabilized at +20 ℃, capacitors shall meet the following limits.				
	Capacitance change	Within ±30% of the initial value			
	Dissipation factor (tan δ)	Less than 300% of the initial value			
	Leakage current	Within the initial limit			
Shelf life	After storage for 1000 h at +105 ℃ ± 2 ℃ with no voltage applied and then being stabilized at +20 ℃, capacitors shall meet the limits specified in endurance.				
Resistance to soldering heat	After reflow soldering and then being stabilized at +20 ℃, capacitors shall meet the following limits.				
	Capacitance change	Within ±10% of the initial value			
	Dissipation factor (tan δ)	Within the initial limit			
	Leakage current	Within the initial limit			
Frequency correction factor for ripple current	Frequency	50Hz	120Hz	1kHz	10kHz≤
	Correction Factor	0.7	1.0	1.3	1.4

Dimensions:

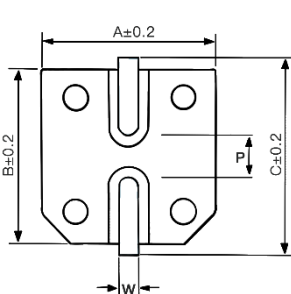
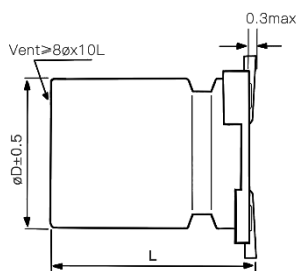

Dimensions						Unit: mm
φ D	L	A	B	C	W	P±0.2
8	10.5±0.5	8.3	8.3	9.2	0.7~1.2	3.1
8	13±0.5	8.3	8.3	9.2	0.7~1.2	3.1
10	10.5±0.5	10.3	10.3	11.2	0.7~1.2	4.4
10	13±0.5	10.3	10.3	11.2	0.7~1.2	4.4

Marking:

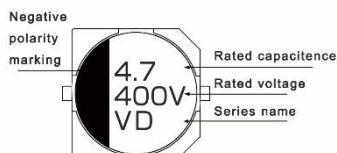

Part Number System:

KVD series	400V	4.7μF	± 20 %	8 φ X10.5L
KVD	2G	4R7	M	0810
Series name	Rated voltage	Capacitance	Capacitance tolerance	Case Size

Characteristics list

Rated voltage (V)	Capacitance (±20%) (μF)	Case size		Specification		Part Number③	Taping&Reel
		øD (mm)	L (mm)	Rated ripple current① (mA rms)	tan δ②		MPQ (pcs/reel)
400	2.2	8	10.5	15	0.25	KVD2G2R2M0810	500
	3.3	8	10.5	20	0.25	KVD2G3R3M0810	500
	4.7	8	10.5	25	0.25	KVD2G4R7M0810	500
		8	13	30	0.25	KVD2G4R7M0813	400
		10	10.5	30	0.25	KVD2G4R7M1010	500
	5.6	8	13	35	0.25	KVD2G5R6M0813	400
		10	10.5	35	0.25	KVD2G5R6M1010	500
	6.8	10	10.5	45	0.25	KVD2G6R8M1010	500
	8.2	10	13	55	0.25	KVD2G8R2M1013	400
	10	10	13	60	0.25	KVD2G100M1013	400

① Rated ripple current (120Hz / +105℃) ② tan δ (120Hz / +20℃) ③ For plastic reel packaging, the Part Number is appended with "PR" at the end.

※ Please refer to the page of reflow conditions for reflow profile.